

LEGEND

- WORK LOCATIONS**
- REMOVE/ABANDON FACILITIES
 - INSTALL FACILITIES
 - MODIFY/TRANSFER/INSTALL ADDITIONAL FACILITIES
- PAD**
- PROPOSED REPLACE PAD 42"x50" - PGB-4399
- VAULT**
- PROPOSED ADD SECONDARY HANDHOLE
 - *PGE PROVIDED AND INSTALLED 1730 VAULT
- CONDUCTORS**
- INSTALL 1 - 830 AL-TX US SECONDARY INSTALLED BY PGE IN 3" PVC CONDUIT PROVIDED & INSTALLED BY PGE APPROVED CONTRACTOR
 - INSTALL 1 - 40 AL-TX US SERVICE INSTALLED BY PGE IN 3" PVC CONDUIT PROVIDED & INSTALLED BY PGE APPROVED CONTRACTOR
 - ABANDON SECONDARY CABLE
 - *GROUND ABANDONED CABLE PER LC24P19-3

TREE TRIMMING NOTES
WL 1 VT-14:
 PRE: REMOVE TREE, INCLUDING ROOTS BENEATH PAD
 POST: REPLACE TREE

PLEASE COORDINATE WITH CREW AND WITH CUSTOMER:
 REYBERT REESE AT 8191 SW KINGFISHER
 503-620-6854

LANDSCAPING NOTES
WL 1 VT-14:
 PRE: PREPARE FOR PAD-MOUNTED TRANSFORMER REPLACEMENT

WL 2 VT-114:
 POST: BEAUTIFY PLANTING AREA AROUND NEW VAULT

PLEASE COORDINATE WITH CUSTOMER:
 MEGAN OR ISAAC MCLOUGHLIN AT
 8246 SW KINGFISHER
 503-200-4917

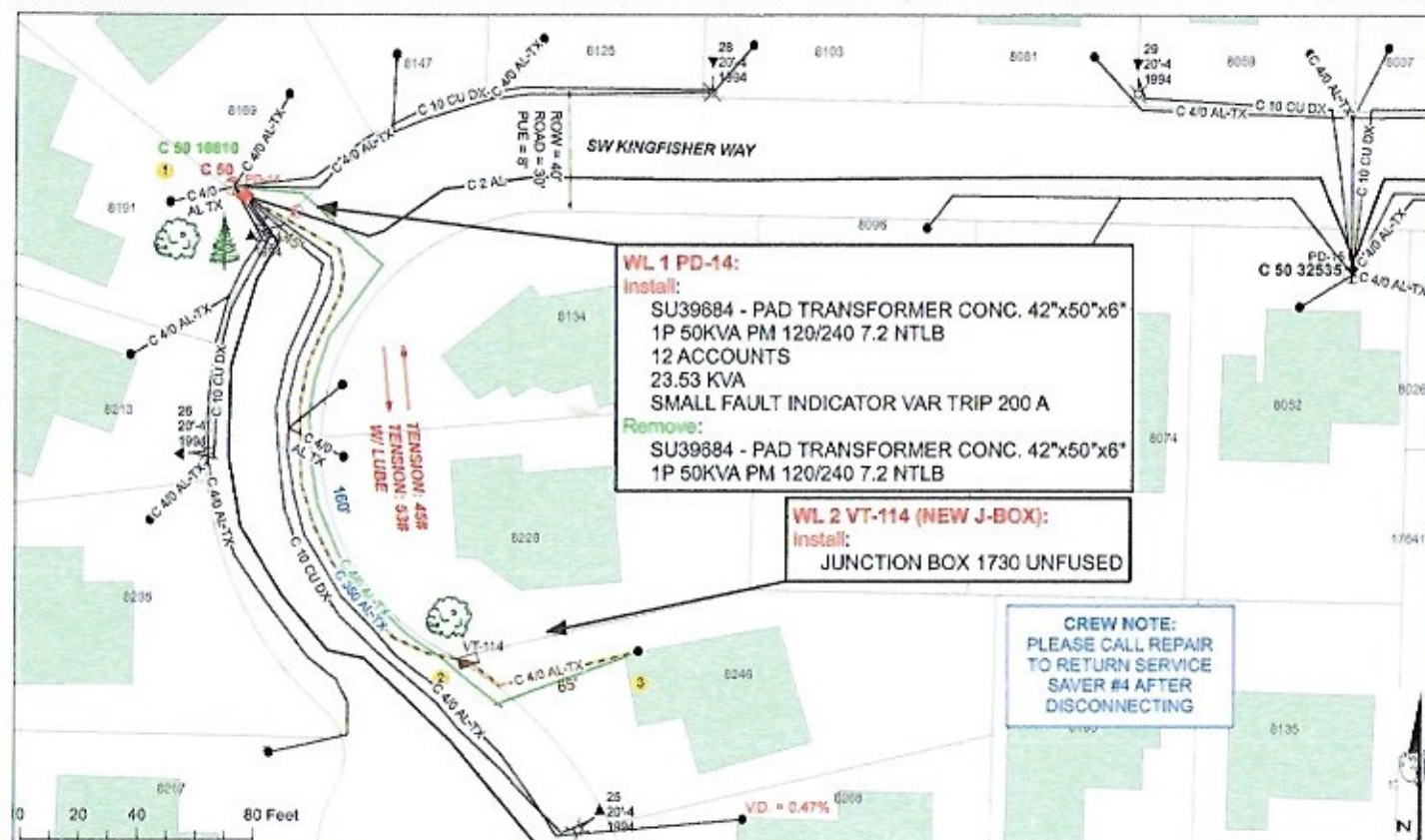

WL 1 PD-14:
Install:
 SU39684 - PAD TRANSFORMER CONC. 42"x50"x6"
 1P 50KVA PM 120/240 7.2 NTLB
 12 ACCOUNTS
 23.53 KVA
 SMALL FAULT INDICATOR VAR TRIP 200 A

Remove:
 SU39684 - PAD TRANSFORMER CONC. 42"x50"x6"
 1P 50KVA PM 120/240 7.2 NTLB

WL 2 VT-114 (NEW J-BOX):
Install:
 JUNCTION BOX 1730 UNFUSED

CREW NOTE:
 PLEASE CALL REPAIR
 TO RETURN SERVICE
 SAVER #4 AFTER
 DISCONNECTING

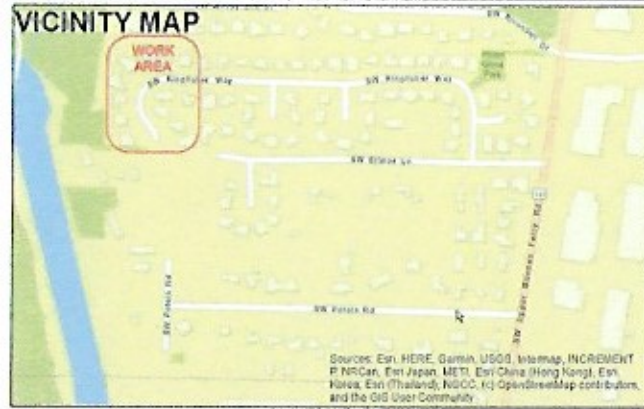

**ANY DEVIATION FROM THIS DESIGN MUST
 BE APPROVED BY THE PGE PROJECT MANAGER**

CALL 811 BEFORE YOU DIG

ATTENTION:
 OREGON LAW REQUIRES YOU TO FOLLOW RULES ADOPTED BY THE OREGON UTILITY NOTIFICATION CENTER. THOSE RULES ARE SET FORTH BY OAR 852-005-0010 THROUGH 852-005-0090 YOU MAY OBTAIN COPIES OF THE RULES BY CALLING THE OREGON UTILITY NOTIFICATION CENTER ADMINISTRATION @ (502) 232-1987.

TO REQUEST UTILITY LOCATES CALL THE OREGON UTILITY NOTIFICATION CENTER, 811 AT LEAST 2 BUSINESS DAYS PRIOR TO EXCAVATION

811
 Know what's below.
 Call before you dig.

PGE CONSTRUCTION DRAWING
AS-BUILT VERIFICATION & NESC VIOLATIONS CORRECTED

Foreman: _____ Date: _____
 General Foreman: _____ Date: _____
(Signature only required for field construction changes.)

SDP/ENG REVIEW: _____ ASBUILT BY DESIGNER: _____

DATE: 3/30/2020 SCALE: 1 in = 40 ft ADDRESS: 1070001 MW: 0000014628 JOB NO: M2848449

PGE

TITLE: REPLACE B/O SECONDARY (SERVICE SAVER) AND PADMOUNT XFMR
 CROOKY DURHAM-BRIDGEPORT SIZE: 11 x 17

LOCATION: 8246 SW KINGFISHER WAY, PORTLAND 97224

DESCRIPTION: REPLACE PD-14 AND SERVICE TO 8246 KINGFISHER

COUNTY: WASHINGTON SECTION: C2113C WORK WITH: _____

DESIGNED BY: MISTY MESAGA PHONE: 503-930-8892 DRAWN BY: MISTY MESAGA

W/3 SW ADDENDUM TO 8246SW001.dwg © PORTLAND GENERAL ELECTRIC CO. - ALL RIGHTS RESERVED

SHEET 1 OF 2